

Installation for the #40R on Synthetic Slate Roofs

- There are three ways to install the #40R snow guard.
 - Option 1:** Carefully lift shingles and position the snow guard in place. Fasten the snow guard through the two holes in the strap, caulking the fasteners above and below.
 - Option 2:** Fasten through the gaps between the slates and fasten through the center of the snow guard strap.
 - Option 3:** If the shingle cannot be lifted or the snow guard cannot be slid into place, the snow guard can be fastened to the row of shingles below. The sleeve is then slid up under the snow guard shingle as far as possible. This will counter flash the fastener heads.
- Slide the sleeve up over the fasteners and under the course of slate above. This counter flashes the fasteners. The caulking from the fasteners heads will hold the sleeve in place.
- Lay synthetic slates back down flat, you may need to use double-sided tape to hold the slates down.

Option 1

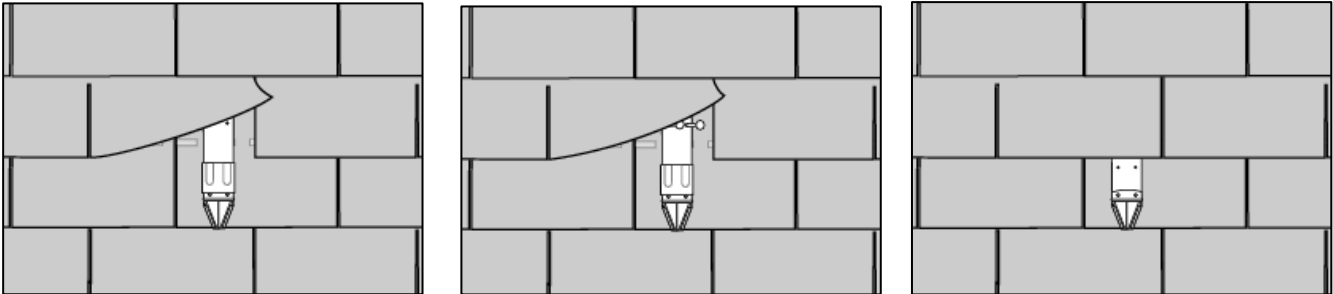

Option 2

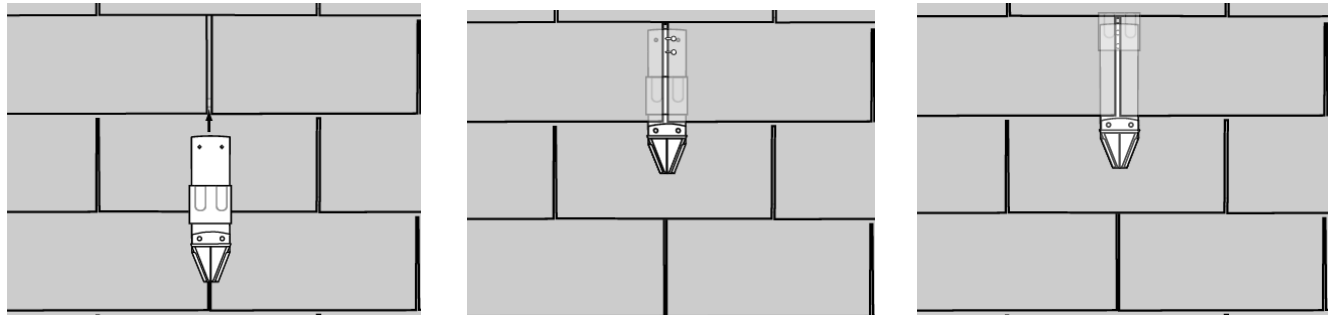

Option 3

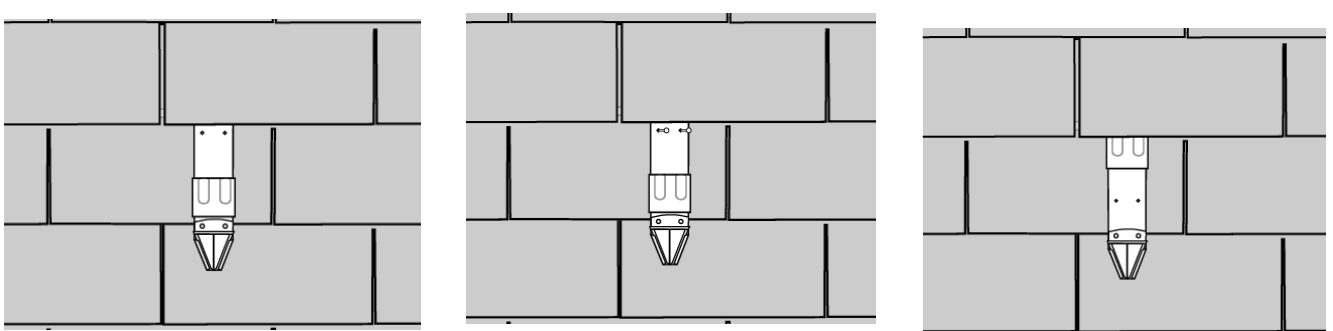

#40R Half-Round Pad-Style Snow Guard for Synthetic Slate



#40R Pad Style Snow Guard Placement Less Than 75 psf Snow Load

On Synthetic Slate Roofs with a 75 psf or Less Design Load and a Less Than 24/12 Pitch

The image below shows a sample installation of a roof with a rafter length greater than 15', a roof pitch of 24/12 or less and a Building Design Load of less than 75 psf. All snow guard installations must have the standard three-row pattern along the eave. Remaining snow guards should be evenly spaced between the top of the three-row pattern to within 10' of the ridge. If the rafter length is less than 15' you only need the three-row pattern which requires 17 snow guards per 10' of eave.

Follow the installation instructions on the previous pages and use the appropriate layout pattern below.

12

If the Building Design Load (snow load) is 75 psf or less and the roof pitch is 24/12 or less you will need 12 snow guards per square using the 2 X 4 layout.

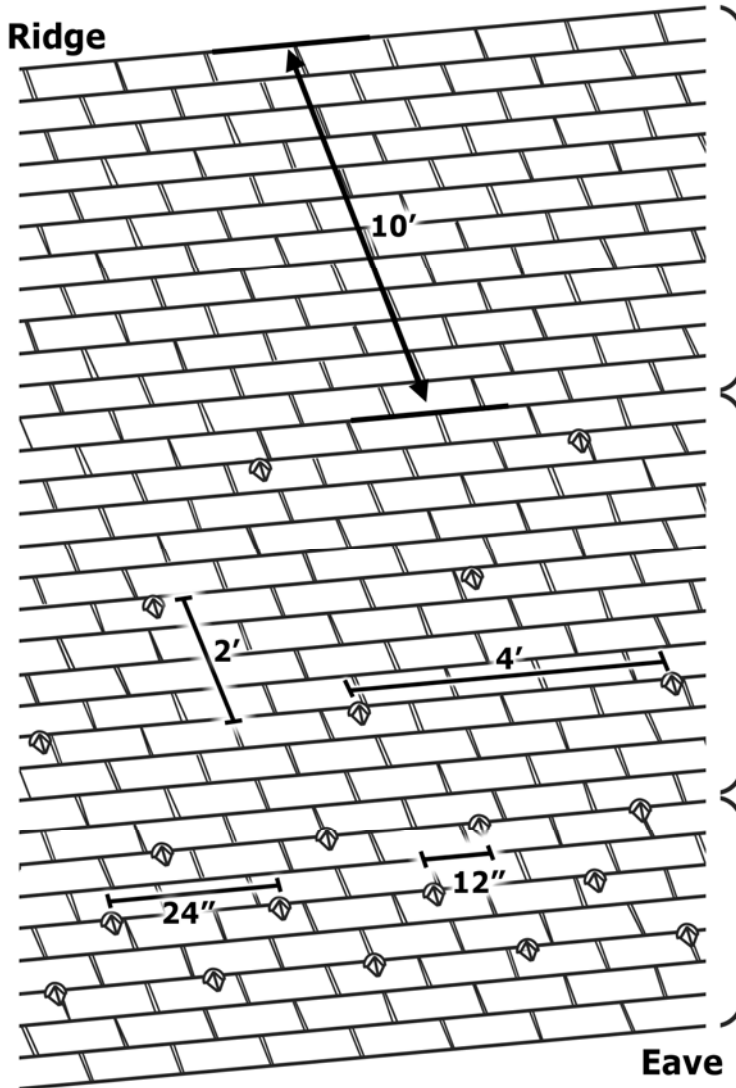

2 X 4 Layout – less than 75 psf Building Design Load and less than 24/12 roof pitch using 12 snow guards per square.

Top ten feet of rafter does not generally require snow guards except in extreme snow load areas.

2 X 4 Supplemental Pattern
This pattern is for installations using 12 snow guards per square including the standard three-row pattern. Space rows 2' vertically and 4' horizontally to within 10' of the ridge.

Standard Three-Row Pattern - for all roofs.
Three rows 24" on center horizontally with the middle row staggered 12".

#40R Half-Round Pad-Style Snow Guard for Synthetic Slate

Pad Style Snow Guard Placement for Extreme Snow Areas Greater Than 75 psf Design Load

Most snow guard installations will use 12 snow guards per square with our standard 2 X 4 layout. If your project is in an extreme snow area, greater than 75 psf you will need to use one of these layouts. If your Design Load is between 75 psf and 110 psf use the 2 X 3 layout. If your Design Load is from 111 psf to 150 psf use the 2 X 2 layout.

Follow the installation instructions on the previous pages and use the appropriate layout pattern below.

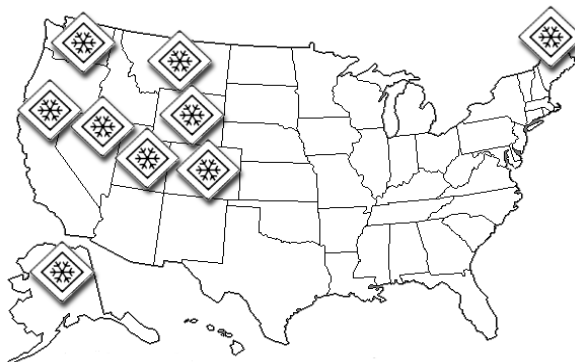

2 X 3 Pattern - for roofs 76 psf to 110 psf, 17 to 21 snow guards per square

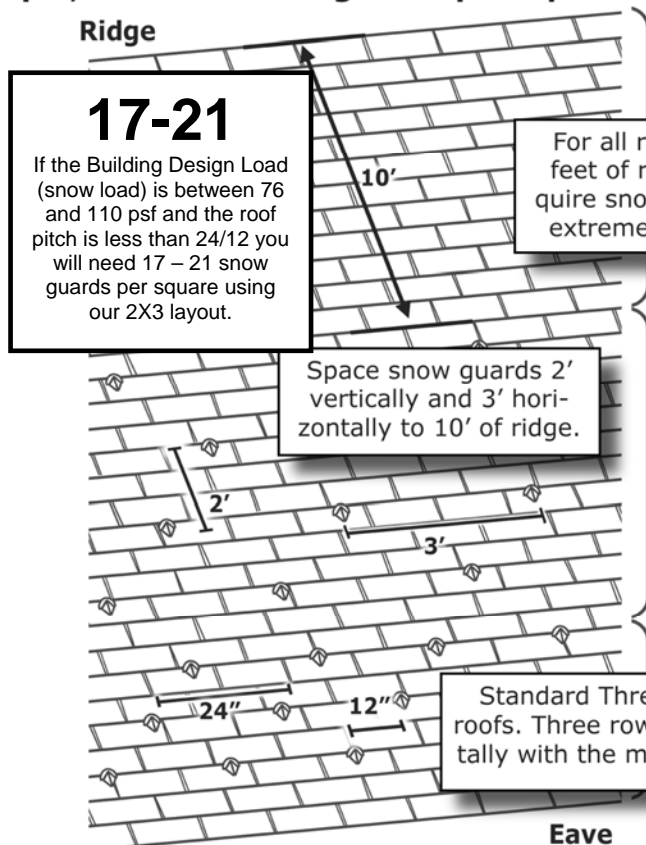

2 X 2 Pattern - for roofs 111 psf to 150 psf, about 22 to 27 snow guards per

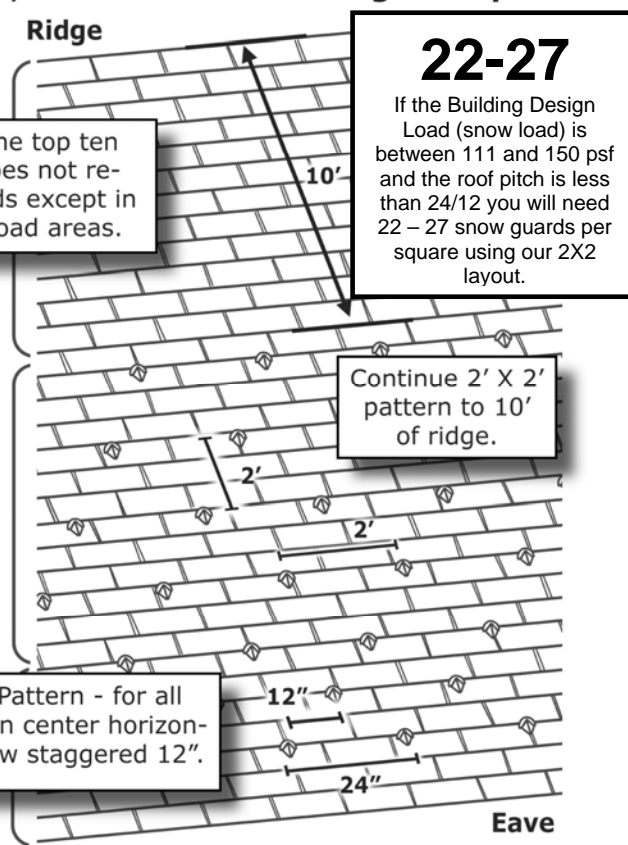

#40R Half-Round Pad-Style Snow Guard for Synthetic Slate