



#40 Pad Style Snow Guard Placement Less Than 75 psf Snow Load

On Synthetic Slate Roofs with a 75 psf or Less Design Load and a Less Than a 24/12 Pitch

The image below shows a sample installation of a roof with a rafter length greater than 15', a roof pitch of 24/12 or less and a Building Design Load of less than 75 psf. All snow guard installations must have the standard three-row pattern along the eave. Remaining snow guards should be evenly spaced between the top of the three-row pattern to within 10' of the ridge. If the rafter length is less than 15' you only need the three-row pattern which requires 17 snow guards per 10' of eave.

Installation Instructions for #40 Pad Style Snow Guard

1. The third row of slate is installed in the usual manner.
2. The snow guard is placed on the slate low enough so that the next course lies properly over the top of the snow guard. The top of the cap should be 3 times the thickness of the slate or a minimum of 5/8" below the bottom of the next row of shingles.
3. Horizontal spacing is 24" on center.
4. Use two fasteners of compatible material on each snow guard. The fasteners are inserted into the two holes on the snow guard strap and through the synthetic slate into the roof deck.
5. Install two more rows of slate and then install another row of snow guards offset 12" horizontally from the first row.
6. Supplemental rows are installed at 48" on center horizontally and 3 courses of shingles vertically.
7. Repeat these steps for the entire snow guard layout.

12

If the Building Design Load (snow load) is 75 psf or less and the roof pitch is 24/12 or less you will need 12 snow guards per square using the 2 X 4 layout.

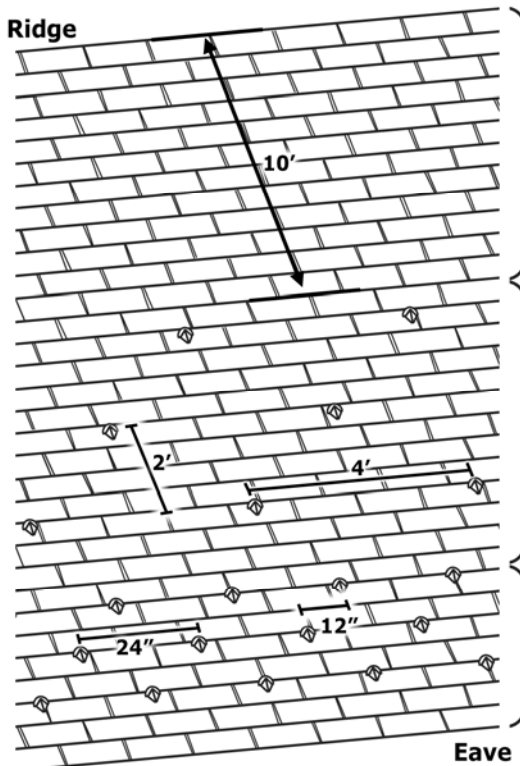

2 X 4 Layout – less than 75 psf Building Design Load and less than 24/12 roof pitch using 12 snow guards per square.

Top ten feet of rafter does not generally require snow guards except in extreme snow load areas.

2 X 4 Supplemental Pattern

This pattern is for installations using 12 snow guards per square including the standard three-row pattern. Space rows 2' vertically and 4' horizontally to within 10' of the ridge.

Standard Three-Row Pattern - for all roofs. Three rows 24" on center horizontally with the middle row staggered 12".

#40 Half-Round Pad-Style Snow Guard for Synthetic Slate

Pad Style Snow Guard Placement for Extreme Snow Areas Greater Than 75 psf Design Load

Most snow guard installations will use 12 snow guards per square with our standard 2 X 4 layout. If your project is in an extreme snow area, greater than 75 psf you will need to use one of these layouts. If your Design Load is between 75 psf and 110 use the 2 X 3 layout. If your Design Load is from 111 psf to 150 psf use the 2 X 2 layout.



Installation Instructions for #40 Pad Style Snow Guard on Roofs

1. The third row of shingles is fastened to the roof in the usual manner.
2. The snow guard is placed on the shingle with the up slope end of the strap resting on the roof deck above the shingle. The snow guard pad should be placed low enough on the shingle so that the next course of shingles, course 4 lays properly over the top of the snow guards, and the pad is set 3 times the thickness of the shingle below the next course. Horizontal spacing should be 24" on center for the first three courses.
3. Two nails or screws of the same or compatible material as the snow guard are inserted through the two holes at the top of the strap to secure the snow guard to the roof deck.
4. Repeat these steps for the entire snow guard layout.

2 X 3 Pattern - for roofs 76 psf to 110 psf, 17 to 21 snow guards per square

Ridge

17-21

If the Building Design Load (snow load) is between 76 and 110 psf and the roof pitch is less than 24/12 you will need 17 - 21 snow guards per square using our 2X3 layout.

Space snow guards 2' vertically and 3' horizontally to 10' of ridge.

For all roofs - the top ten feet of rafter does not require snow guards except in extreme snow load areas.

2 X 2 Pattern - for roofs 111 psf to 150 psf, about 22 to 27 snow guards per square

Ridge

22-27

If the Building Design Load (snow load) is between 111 and 150 psf and the roof pitch is less than 24/12 you will need 22 - 27 snow guards per square using our 2X2 layout.

Continue 2' X 2' pattern to 10' of ridge.

Standard Three-Row Pattern - for all roofs. Three rows 24" on center horizontally with the middle row staggered 12".

Eave

Eave

#40 Half-Round Pad-Style Snow Guard for Synthetic Slate



Placement for #10 Pad-Style Snow Guard on Synthetic Slate & Shake Roofs

NOTES:

1. SNOW GUARDS TO BE INSTALLED ACCORDING TO MANUFACTURER'S SPECIFICATIONS.
2. DO NOT SCALE DRAWINGS.
3. CONTACT MANUFACTURER FOR CUSTOM MATERIALS AND COLORS.
4. CONTACT MANUFACTURER FOR SUGGESTED LAYOUT.

REVISIONS		
REV.	DESCRIPTION	DATE

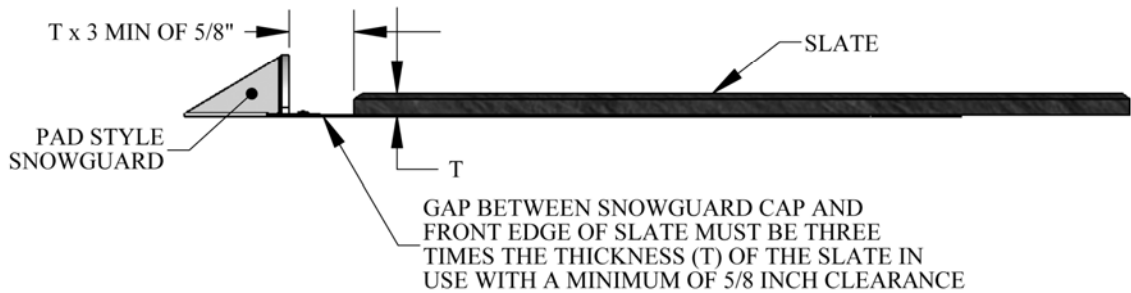
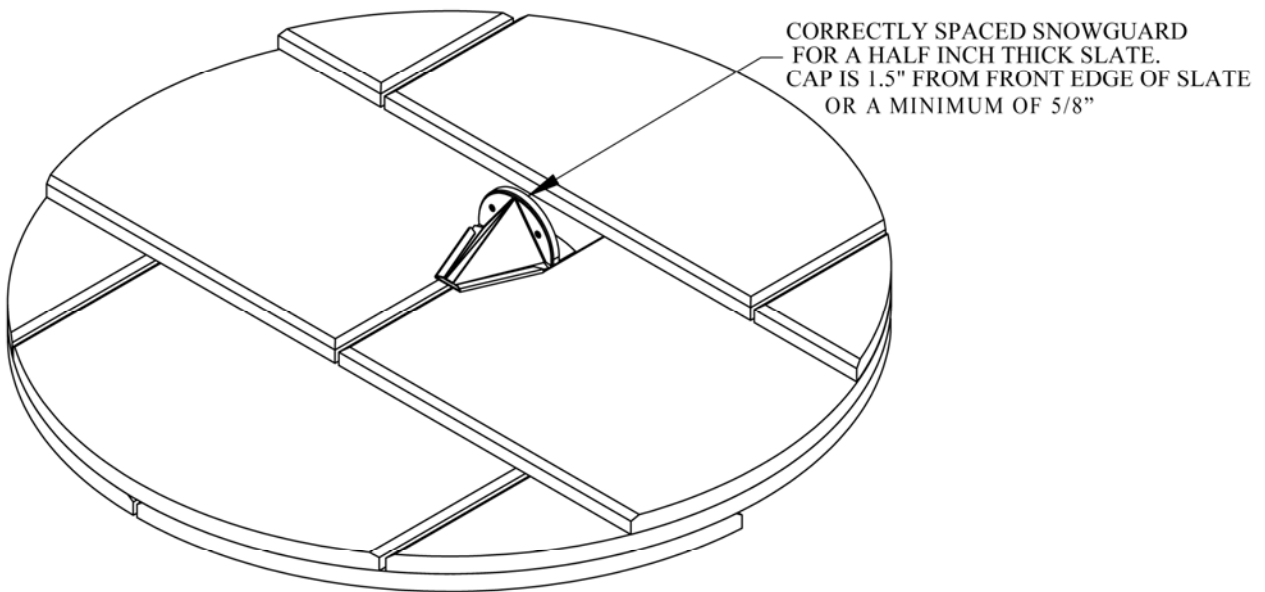

#40 Half-Round Pad-Style Snow Guard for Synthetic Slate